

Broadband RF Power MOSFET

The high power transistor part number IDM30512CW100 is designed for VHF/UHF-Band systems operating over the frequency band 30-512 MHz under CW conditions. Over the instantaneous operating band of 30-512MHz this dual MOSFET device is capable of supplying a minimum of 100 watts of output power. All devices are 100% screened in a narrowband RF test fixture to supply a minimum of 300W of output power at 400MHz.



Silicon MOSFET

- High Power Gain
- Superior thermal stability

Class AB Operation

- Gate biased to $I_{DQ}=2x100mA$

Configuration

- Common Source

Gold Metal

- Maximum Reliability

BeO Package

- Unmatched Thermal Reliability

Epoxy Sealed Lid

- Gross Leak Qualified

RF Test Fixture

- Narrowband
- Matched to 50Ω
- Long-term Correlation
- 100% Device RF Screening
- No External Tuning required

TYPICAL DATA TYPICAL DATA TYPICAL DATA TYPICAL DATA

Device	Freq (MHz)	V _{DD} (V)	P _{IN} (W)	IRL (dB)	P _{OUT} (W)	Gain (dB)	I _D (A)	η _d (%)
D5228-1	200	28	9.9	10	330	15.2	18.1	65.2
D5228-1	300	28						
D5228-1	400	28	37.4	20	330	9.46	16.9	69.8
D5228-1	500	28						

MAXIMUM RATINGS

Screen	Parameter	Symbol	Min	Max	Units	Test Conditions
BD	Drain-Source Voltage	V_{DS}	--	80	V	--
BD	Gate-Source Voltage	V_{GS}	--	20	V	--
BD	Storage Temperature Range	T_{STG}	-55	+125	°C	--
BD	Operating Junction Temperature Range	T_J	-55	+200	°C	--
Note	Screen 'BD' = parameter qualified By Design.					

THERMAL CHARACTERISTICS

Screen	Parameter	Symbol	Min	Max	Units	Test Conditions
BD	Thermal Resistance	$R_{TH(JC)}$	--	0.36	°C/W	$V_{CC}=28V, I_{DQ}=2x100mA, T_F=25\pm5^\circ C, P_{OUT}=300W$
Note	Screen 'BD' = parameter qualified By Design.					

PROCESSING SPECIFICATIONS

Screen	Parameter	Symbol	Min	Max	Units	Test Conditions
100%	DC Wafer Probe	--	--	--	--	Per Integra specification.
Q1	Wafer DC and RF Qualification	--	--	--	--	Per Integra specification.
LM	Wire Bond Strength	--	--	--	--	Line monitor per Integra specification.
100%	Pre-cap visual inspection	--	--	--	--	Per Integra specification
100%	Gross leak test	--	--	--	--	MIL-STD-750D, Method 1071, Test Condition C
Note	Screen 'Q1' = parameter is qualified by assembly and test of 3 pieces minimum per wafer.					
Note	Screen 'LM' = parameter is qualified by assembly line monitor.					

DC ELECTRICAL CHARACTERISTICS

Screen	Parameter	Symbol	Min	Max	Units	Test Conditions
100%	Drain-Source Breakdown Voltage	BV_{DSS}	70	--	V	$I_D = 40mA, V_{GS} = 0V, T_F = 25\pm5^\circ C$
100%	Drain Leakage Current (each side)	I_{DSS}	--	100	μA	$V_{DS} = 28V, V_{GS} = 0V, T_F = 25\pm5^\circ C$
100%	Gate Threshold Voltage 2 (each side)	V_{GSTH2}	1.5	--	V	$I_D = 100mA, V_{GS} = 10V, T_F = 25\pm5^\circ C$

RF ELECTRICAL CHARACTERISTICS

Screen	Parameter	Symbol	Min	Max	Units	Test Conditions
100%	Input Return Loss	IRL	10		dB	$V_{DD}=28V, I_{DQ}=2x100mA, T_F=25\pm 5^{\circ}C, P_{IN}=37.4W, F=400MHz$
100%	Output Power	P_o	300		W	$V_{DD}=28V, I_{DQ}=2x100mA, T_F=25\pm 5^{\circ}C, P_{IN}=37.4W, F=400MHz$
100%	Drain Efficiency ($P_o/I_D/V_{DD}$)	N_D	50		%	$V_{DD}=28V, I_{DQ}=2x100mA, T_F=25\pm 5^{\circ}C, P_{IN}=37.4W, F=400MHz$
BD	Input Capacitance	C_{ISS}		320	pF	$V_{DD}=28V, V_{GS}=0V, F=1MHz$
BD	Output Capacitance	C_{OSS}		160	pF	$V_{DD}=28V, V_{GS}=0V, F=1MHz$
BD	Reverse Transfer Capacitance	C_{RSS}		19	pF	$V_{DD}=28V, V_{GS}=0V, F=1MHz$
Note 2	T_F = Device flange temperature.					

RF TEST FIXTURE IMPEDANCE CHARACTERISTICS

Frequency (MHz)	$Z_{IF} (\Omega)$	$Z_{OF} (\Omega)$
200	3.60+j3.94	6.66-j0.18
300	--	--
400	0.96-j1.90	2.74-j2.12
500	--	--
Impedance Definition		

Note : Input and output impedances are measured from gate to gate and drain to drain respectively.

PACKAGE DIMENSIONAL OUTLINE DRAWING

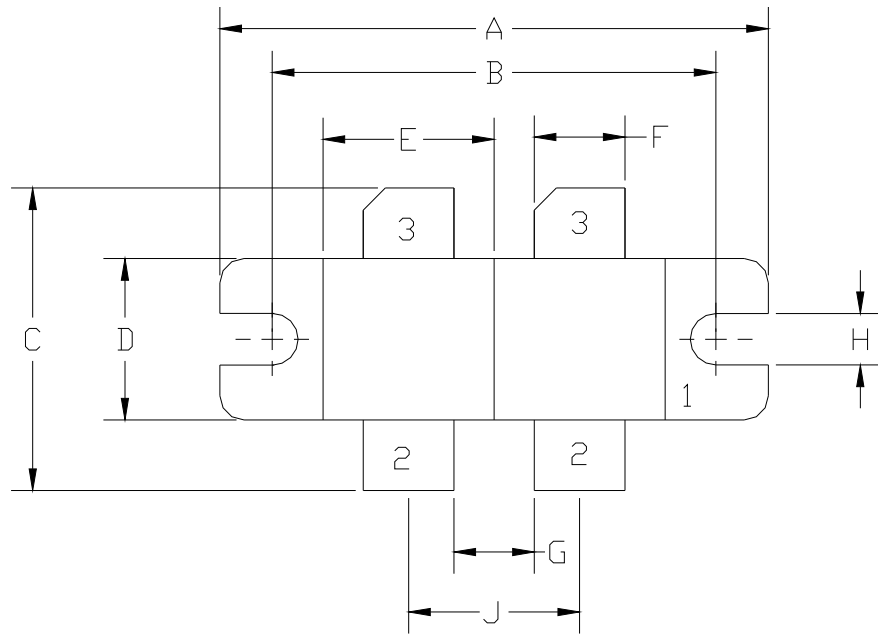

DIM	INCHES		MILLIMETERS	
	MIN	MAX	MIN	MAX
A	1.330	1.350	33.80	34.30
B	1.095	1.105	27.81	28.07
C	0.740	0.760	18.80	19.30
D	0.395	0.405	10.03	10.29
E	0.419	0.429	10.64	10.90
F	0.220	0.230	5.59	5.84
G	0.194	0.204	4.93	5.18
H	0.123	0.133	3.12	3.38
J	0.419	0.429	10.64	10.90
K	0.062	0.072	1.58	1.83
L	0.097	0.117	2.47	2.97
M	0.193	0.225	4.90	5.72
N	0.003	0.006	0.08	0.15

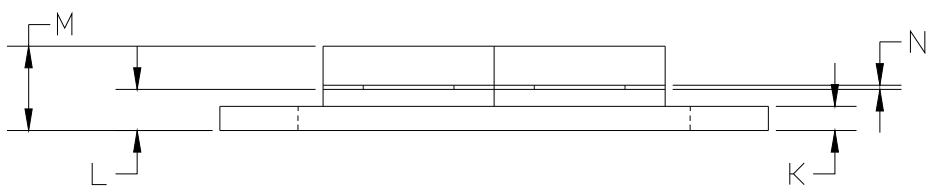

PIN	SCHEDULE
1	SOURCE
2	GATE
3	DRAIN

DEFINITIONS

Data Sheet Status	
Proposed Specification	This data sheet contains proposed specifications.
Preliminary Specification	This data sheet contains specifications based on preliminary measurements and data.
Product Specification	This data sheet contains final product specifications.
Maximum Ratings	
Stress above one or more of the maximum ratings may cause permanent damage to the device. These are maximum ratings only. Operation of the device at these or at any other conditions above those given in the characteristics sections of the specification is not implied. Exposure to maximum values for extended periods of time may affect device reliability.	

WARNING

Product and environmental safety - toxic materials
This product contains beryllium oxide. The product is entirely safe provided that the BeO base is not damaged. All persons who handle, use or dispose of this product should be aware of its nature and of the necessary safety precautions. After use, dispose of as chemical or special waste according to the regulations applying at the location of the user. It must never be thrown out with general or domestic waste.

DISCLAIMER

Integra Technologies Inc. reserves the right to make changes without further notice to any products herein. Integra Technologies Inc. makes no warranty, representation or guarantee regarding the suitability of its products for any particular purpose, nor does Integra Technologies Inc. assume any liability arising out of the application or use of any product or circuit, and specifically disclaims any and all liability, including without limitation consequential or incidental damages. Integra Technologies Inc. products are not designed for use in life support appliances, devices, or systems where malfunction of these products can reasonably be expected to result in personal injury. Integra Technologies Inc. customers using or selling these products for use in such applications do so at their own risk and agree to fully indemnify Integra Technologies Inc. for any damages resulting from such improper use or sale.
--